

# REED SWITCH MKA-20103

## CONTACT FORM A NORMALLY OPEN CONTACTS

Switching current 1,0 A

Switching power 50 W, VA

Switching voltage 250 V

Pull in range 20...50 AT

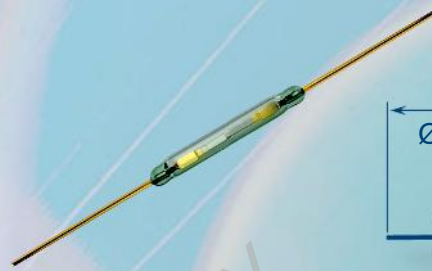

### Dimensions

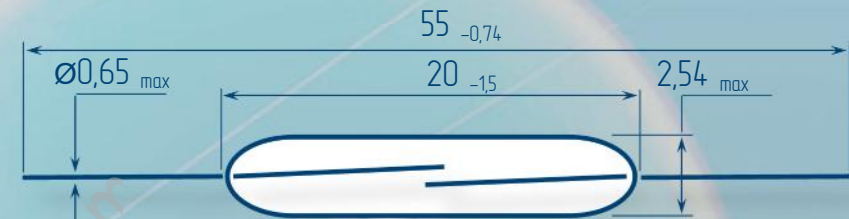

### Electrical Data

Release range, AT, min	8
Carry current, A	2,0
Breakdown voltage less 25 A more 25 A	
V, not less, AC/DC	220/300 280/400
Resetting Ratio	0,4...0,9
Contact resistance, Ω, not more	0,1
Operating time including bounce, ms, not more	0,75
Release time including bounce ms, not more	0,3
Capacitance, pF, not more	0,4
Insulation resistance, GΩ, not less	10
Operating frequency, Hz	100
Switching current frequency, kHz, not more	10

### Environmental Data

Contact material	Ru
Life expectancy, switching cycles x10 <sup>6</sup> max load power... low load power	0,025...10
Vibration (1...2000 Hz), g, not more	30
Resonant frequency, Hz	2600
Shock (1±0,3) ms, g, not more	150
Weight, g, not more	0,36
Operating temperature, °C	-60...125
Humidity, %, not more	98

### Certificates



### Test Coil

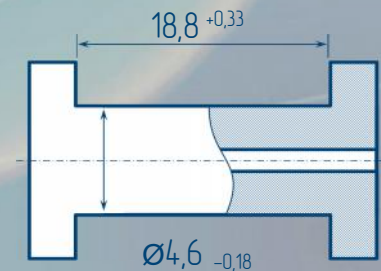

5000 turns, wire Ø0,063 mm  
coil resistance 550

### Order information

Delivery of reed switches with formed and/or cropped leads and with narrow pull in ranges is available by agreements.



RYAZAN METAL CERAMICS INSTRUMENTATION PLANT, JSC  
51V, Novaya St., 390027, Ryazan, Russia  
Phone: +7 (4912) 240-234, Факс: +7 (4912) 240-234 E-mail: ives@rmcip.ru

Update on 19 November 2013

